



EN ■ Coffeemaker

READ CAREFULLY AND STORE FOR FUTURE USE.

- This appliance may be used by children 8 years of age and older and by persons with physical or mental impairments or by inexperienced persons, if they are properly supervised or have been informed about how to use the product in a safe manner and understand the potential dangers. Children must not play with the appliance. Cleaning and user maintenance must not be performed by children unless they are older than 8 years of age and under supervision. Keep this appliance and the power cord out of reach of children younger than 8 years of age.
- This appliance is designed for domestic use and similar locations such as:
 - staff kitchens in stores, offices and other workplaces;
 - hotel or motel rooms and other living areas;
 - agricultural farms;
 - bed and breakfast establishments.
- The appliance is intended exclusively for brewing filtered coffee or tea.



Warning:

Incorrect use may lead to injuries.

- Before connecting the appliance to a power socket, check that the nominal voltage on its rating label matches the electrical voltage in the power socket. Connect the appliance only to a properly grounded socket.
- Do not place the appliance on or near an electrical or gas stove, or in the vicinity of an open flame.
- The appliance must always be located on a stable, horizontal and dry surface. Do not place it on window sills, kitchen sink drainboards, etc.
- Never use the appliance in the near vicinity of a bath, shower or swimming pool.
- Do not use the warming plate and lid of the appliance as a shelf for placing items.
- Only fill the water tank with cold drinking water. Do not pour heated or sparkling water, milk or any other liquids into it or place any items inside it. The maximum capacity of the water tank is 1.8 litres. Do not overfill the water tank.
- Use the appliance with the glass kettle that came with it. Do not overfill the glass kettle or place it on other sources of heat or use it for heating liquids or food in a microwave oven.
- Do not use the appliance with a glass kettle that is cracked or that has a loosened or damaged handle, etc. If the kettle exhibits any signs of damage, it must be replaced with a new one.
- The appliance must not be used without the filter holder and the coffee filter. Never put ground coffee or tea leaves directly into the filter holder.
- Before turning on the appliance, make sure that the water tank is filled with water and that the kettle is placed on the warming plate.



Warning:

Do not open the lid while brewing tea or coffee. Do not touch the hot surface of the warming plate or the glass kettle. This could cause burns. Use the handle for lifting and carrying.

- Hot steam is released from the vents during operation. For this reason, provide the appliance with at least 20 cm of clearance space.
- Due to residual heat, the accessible surfaces of the appliance remain hot after it is turned off.
- Pay extra attention when handling the kettle filled with hot liquid to prevent scalding.
- Do not submerge a heated kettle in ice-cold water. Do not leave an empty kettle sitting on the warming plate when it is turned on. This could damage it.
- Before using the appliance again, turn it off and allow it to cool down for 10 minutes. Make sure that the appliance is turned off before filling the water tank.
- The appliance is equipped with a safety thermal fuse that automatically cuts off the electrical circuit when overheating occurs. In the event that such a situation occurs, disconnect the appliance from the power socket and allow it to cool down. After it has cooled down, you may continue using the appliance. Do not fill the water tank with cold water for the purpose of cooling down the heating element.
- Keep the appliance clean. Clean it according to the instructions in chapter Cleaning and maintenance.
- Before cleaning or moving it, always turn off the appliance, disconnect it from the power socket and allow it to cool down. Do not move the appliance with the water tank filled with water or with the kettle located on the warming plate.
- Do not rinse the appliance, except for the removable parts, under running water and do not submerge it in water or any other liquid.
- Ensure that the power cord does not hang over the edge of a table or come into contact with water or moisture or a heated surface.
- Disconnect the appliance from the power socket by pulling on the plug, never pulling on the power cord. Otherwise, this could damage the power cord or the socket.
- In the event that the power cord is damaged, have it repaired at a professional service centre to prevent causing a dangerous situation. It is forbidden to use the appliance if it has a damaged power cord.
- To avoid the danger of injury by electrical shock, do not repair the appliance yourself or make any adjustments to it. Have all repairs of the appliance performed at an authorised service centre. Tampering with the appliance during the warranty period may void the warranty.

A

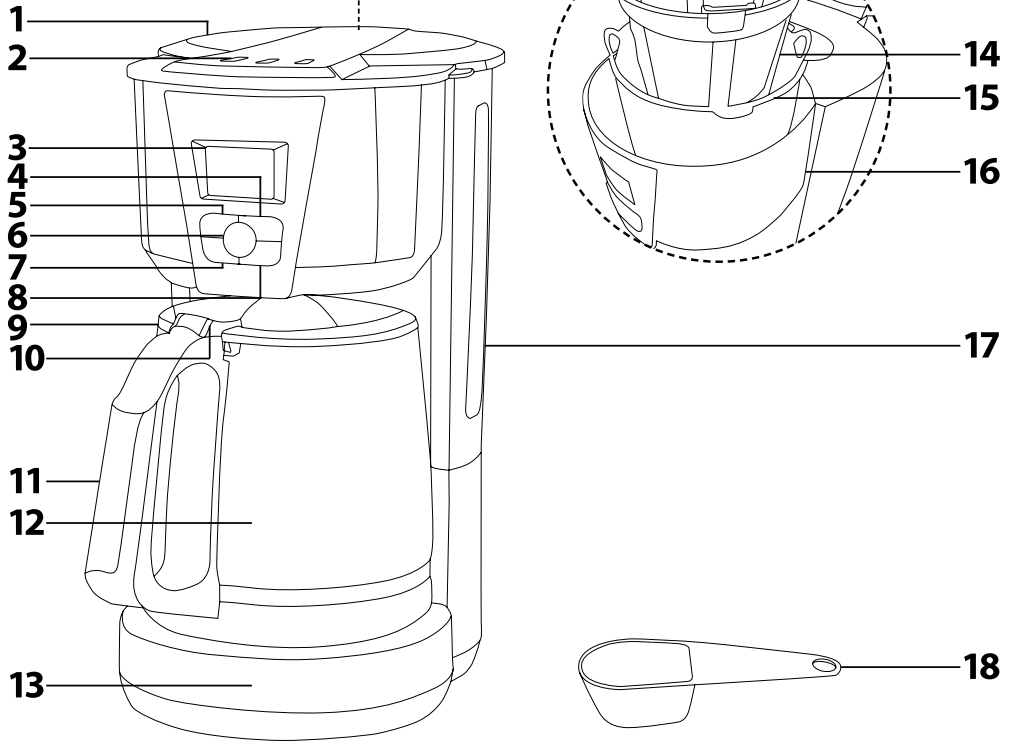

- Prior to using this appliance, please read the user's manual thoroughly, even in cases, when one has already familiarised themselves with previous use of similar types of appliances. Only use the appliance in the manner described in this user's manual. Keep this user's manual in a safe place where it can be easily retrieved for future use.
- We recommend saving the original shipping cardboard box, packaging material, receipt and warranty card for the duration of warranty. In the case of transportation, pack the appliance using the original packaging materials only.

DESCRIPTION OF THE COFFEEMAKER

- | | |
|--|---|
| A1 Lid of the water tank and steam chamber | A7 HOUR button
it is used to set the hours. |
| A2 Vents | A8 MIN button
it is used to set the minutes. |
| A3 Backlit LCD display shows the time, timer settings and status, and the strong coffee flavour setting. | A9 Glass kettle lid |
| A4 STRONG button
it is used to activate and deactivate the strong coffee flavour setting. | A10 Lip for opening the glass kettle lid |
| A5 PROG button
it is used to set the automatic start timer. | A11 Glass kettle handle |
| A6 ON/OFF AUTO button with indicator light
it is used to turn the coffeemaker on and off and to turn on the timer. | A12 Glass kettle |
| | A13 Warming plate
keeps the coffee at an optimal serving temperature. |
| | A14 Permanent removable coffee filter |
| | A15 Removable filter holder
with closable Drip-Stop valve |
| | A16 Brewing chamber |
| | A17 Water tank with water level mark |
| | A18 Coffee measuring cup |

BEFORE FIRST USE

- Take the coffeemaker out of the packaging material and remove all promotional labels and stickers from it.
- Thoroughly wash the permanent filter **A14**, filter holder **A15**, the glass kettle **A12** and the measuring cup **A18** in warm water using kitchen detergent. Then rinse these parts under clean running water and dry them.
- Fill the water tank **A17** with cold drinking water up to the maximum mark MAX/15. Place the filter holder **A15** into the brewing chamber **A16**. The holder **A15** can be inserted into the brewing chamber **A16** in only one direction. Place the permanent filter **A14** into the holder **A15** making sure that it properly slides in along the entire perimeter.
- Close the lid **A1** and place the glass kettle **A12** with the lid **A9** closed on to the warming plate **A13**.
- Connect the power cord to a power socket and press button **A6**. Allow the contents of the water tank **A17** to flow into the glass kettle **A12**. After dripping the contents of the water tank **A17** into the kettle **A12**, the coffeemaker will automatically switch to the KEEP WARM mode. To turn off the coffeemaker, press button **A6** twice. Empty the contents of the kettle **A12** and allow the coffeemaker to cool down for at least 10 minutes.
- Now the coffeemaker is ready for use.

SELECTING A COFFEE FILTER

- This coffeemaker is supplied with a permanent filter **A14** that can be used repeatedly. Instead of it, one can use disposable paper filters size no. 4, which can normally be purchased at online or brick-and-mortar stores. It is necessary to fold over the top edge of the paper filter.

OPERATING THE COFFEEMAKER

- Connect the power cord to a power socket. After connecting to a power socket, the display **A3** will be lit and show the time ^{MM}12:00. If no button is pressed within 15 seconds, the backlight of the display **A3** will turn off. When any button is pressed, the display **A3** will again be lit.

SETTING THE CURRENT TIME

- Use button **A7** to set the hours. Each time the button is pressed, the time will increase by 1 hour. To speed up the hour setting process, hold down button **A7**.
- Use button **A8** to set the minutes. Each time the button is pressed, the time will increase by 1 minute. To speed up the minute setting process, hold down button **A8**.
- The time on display **A3** is shown in 12-hour format. The morning and afternoon time is indicated by AM and PM.
- Time cannot be set when the indicator of button **A6** is lit red.

BREWING COFFEE

- Open the lid **A1** and fill the water tank **A17** with the required amount of water. The water level in the water tank **A17** should cover at least the minimum level line MIN/3 (i.e. 3 cups of water), but must not exceed the maximum level line MAX/15 (i.e. 15 cups of water). The kettle **A12** or another suitable container can be used to pour water into the water tank **A17**. Never fill the water tank **A17** directly underneath a water tap.



Attention:

Only fill the water tank **A17** with cold drinking water. Do not use heated or sparkling water, etc.

The water tank **A17** has a maximum capacity of 1.8 litres.

The amount of brewed coffee will always be less than the amount of water you poured into the water tank **A17**. During the coffee brewing process, approximately 10% of the water is absorbed by the ground coffee.

- Place the filter holder **A15** into the brewing chamber **A16**. The holder **A15** can be inserted into the brewing chamber **A16** in only one direction. Place the permanent filter **A14** or a disposable paper filter size no. 4 into the filter holder **A15**. Make sure that the permanent filter **A14** slides into the filter holder **A15** along the entire perimeter. It is necessary to fold over the top edge of the paper filter.
- Pour the required amount of ground coffee into the filter. The recommended dosage is 7 g of ground coffee per cup. The included measuring cup **A18** can be used for measurement.



Note:

If you wish to brew tea, measure out the required amount of loose tea and pour this into the filter.

- Shut the lid **A1** and make sure that it is properly closed.
- Place the glass kettle **A12** with the lid **A9** closed on to the warming plate **A13** and start the coffeemaker by pressing button **A6**. The indicator light will be lit red and after a short moment the coffee brewing process will start and the warming plate **A13** will start to heat up.
- If you wish to prepare coffee with a stronger flavour, press button **A4**. The message BOLD will appear on the display **A3**. Press button **A4** again to cancel this setting. The message on the display **A3** will turn off.
- When the brewing process is complete, the indicator light will flash and the coffeemaker will switch to the KEEP WARM mode. In this mode the warming plate **A13** will keep the coffee warm for 40 minutes so that it is ready to be served at a later time. Then the coffeemaker will turn off automatically. The turning off of the coffeemaker is indicated by the indicator light turning off.
- You may serve the coffee immediately after brewing it or later. When serving it later, leave it on the warming plate **A13** so that it does not go cold.
- Check that the coffeemaker is turned off before putting the empty kettle **A12** back on the warming plate **A13**. If the coffeemaker is still in the KEEP WARM mode, press button **A6** twice to turn it off.
- Allow the coffeemaker to cool down for at least 10 minutes before using it again.



Warning:

If you were not to allow the coffeemaker to cool down, then it could overheat.

- Before using the coffeemaker again, remove the coffee grounds and wash out the permanent filter **A14**, the filter holder **A15** and the kettle **A12** under running water. Dry all these parts and then put them back in their place. If you used a paper filter, dispose of it with household waste. The coffee grounds may be disposed of as bio-waste.
- When you have finished using it, make sure that the coffeemaker is turned off.

DRIP-STOP FUNCTION

- The Drip-Stop function will allow you to serve coffee even before the end of the brewing process.
- When the kettle **A12** is removed from the coffeemaker, the Drip-Stop valve is engaged and the coffee will stop dripping.
- The kettle **A12** must be put back on the warming plate **A13** within approximately 30 seconds of taking it off to avoid the filter from overflowing with hot water.
- When the kettle **A12** is placed back on to the warming plate **A13**, the dripping process will resume automatically.



Note:

Coffee served prior to the completion of the brewing process may taste differently to the coffee served at the end of the brewing process.

AUTOMATIC START TIMER FUNCTION

- The timer function enables coffee brewing to be postponed to a later time. This can be utilised if you wish to have freshly brewed coffee in the morning when you get up.
- While the coffeemaker is turned off, press button **A5** to set the timer. When button **A5** is pressed, the display **A3** will switch to the timer display mode. This is the time when the coffeemaker will automatically turn itself on. The message AUTO will flash on the display **A3**. To set the automatic start time, use buttons **A7** and **A8**. To finish setting the timer, press button **A5** again. Display **A3** will switch to the current time display mode.



Note:

If you do not press any button in the timer setting mode within 10 seconds, the setting mode will be cancelled and the display **A3** will automatically switch to the current time display mode.

- To turn on the timer, press button **A6** twice. The message AUTO will appear on the display **A3** and the indicator light **A6** will be lit green. The coffeemaker will automatically start at the preset time. Before turning on the timer, make sure that the water tank **A17** is filled with the required amount of water and that the required amount of ground coffee is in the filter. The lid **A1** of the coffeemaker must be properly closed and the glass kettle **A12** must be located on the warming plate **A13**.
- If you wish to prepare coffee with a stronger flavour, press button **A4**. The message BOLD will appear on the display **A3**.

**Attention:**

For the coffee to start brewing at the required time, the correct current time must be set.

In the event that the coffeemaker is disconnected from the mains power socket or if there is a power outage before the coffeemaker starts automatically, it is necessary to set the clock and timer again.

- To display the timer, press button **A5**. The set automatic start time will appear on the display **A3** for 10 seconds. Then the display **A3** will switch back to the current time display mode. The message AUTO will be lit on the display **A3** and indicator light **A6** will be lit green. This indicates that the timer function is activated.
- To turn off the timer, press button **A6**. The indicator light **A6** will turn off.

BASIC GUIDELINES FOR BREWING FINE TASTING COFFEE

- Always brew coffee in a clean coffeemaker. A dirty coffeemaker can negatively impact the taste of the coffee beverage. Instructions for cleaning and removing limescale deposits are found in chapter Cleaning and maintenance.
- Always brew coffee using cold drinking water.
- Brew the coffee using ground coffee intended for coffeemakers or from freshly ground coffee beans. Coffee brewed from freshly ground coffee beans will have a better taste and aroma than coffee brewed using coffee beans ground in advance. When grinding coffee, it is important to adhere to the instructions below.
- Grind the coffee beans to a fine texture but not too fine. If the ground coffee resembles fine flour when sifted between the fingers, then water will take too long to flow through the coffee and the resulting beverage will be too dark and bitter, or the coffee filter may become clogged or the brewing chamber **A16** may overflow. If you grind the coffee beans too coarsely, water will flow through too fast and more ground coffee will be needed per cup to achieve optimal taste and aroma.
- Store ground coffee in an enclosed container, in dry and cool conditions. Do not place it in a refrigerator or freezer. Consume within a week of first opening it.

CLEANING AND MAINTENANCE**CLEANING AFTER EVERY USE**

- Before cleaning it, turn off the coffeemaker, disconnect it from the power socket and allow it to cool down.
- After every use, remove the coffee grounds and wash out the permanent filter **A14**, the filter holder **A15** and the glass kettle **A12** in warm water. Then dry these parts with a wiping cloth.
- If you used a paper filter, dispose of it with household waste. The coffee grounds may be disposed of as bio-waste.

**Note:**

To clean the permanent filter **A14** you may use a nylon brush.

- Clean the outer surface of the coffeemaker with a lightly dampened cloth and then wipe it dry. You may use neutral kitchen detergent to remove coffee stains.
- For cleaning, never use abrasive cleaning products, solvents, etc.

REMOVING LIMESCALE DEPOSITS

- It is necessary to regularly remove limescale deposits from the coffeemaker. Limescale deposits may prolong the coffee brewing time and negatively affect the quality of the brewed coffee.
- In the case of daily use of the coffeemaker, we recommended to remove the limescale deposits:
 - once per month in areas with hard or very hard water;
 - once every 2 to 3 months in areas with soft or medium soft water.
- To remove limescale deposits, use a solution prepared from water and 8% white vinegar. The recommended solution ratio is 2:1. Fill the water tank **A17** with the solution all the way up to the maximum level mark. Insert the filter holder **A15** and the permanent filter **A14** into the brewing chamber **A16**. Close the lid **A1** and place the glass kettle **A12** on the warming plate **A13**.
- Connect the power cord to a power socket and press button **A6**. Allow the contents of the water tank **A17** to flow into the glass kettle **A12**. After dripping the contents of the water tank **A17** into the kettle **A12**, the coffeemaker will automatically switch to the KEEP WARM mode. To turn off the coffeemaker, press button **A6** twice. Empty the contents of the kettle **A12** and allow the coffeemaker to cool down for at least 10 minutes.

**Warning:**

When cleaning, a larger amount of steam may escape from the vents **A2** than when brewing coffee. Do not touch the lid **A1** while the coffeemaker is in operation.

- After using the solution, allow clean water to run through the coffeemaker two to three times. Allow the coffeemaker to cool down for at least 10 minutes between the individual cleaning cycles.

TECHNICAL SPECIFICATIONS

Rated voltage range.....	220–240 V
Rated frequency.....	50/60 Hz
Rated power input.....	1 000 W
Water tank capacity.....	1.8l

We reserve the right to change text and technical specifications.

INSTRUCTIONS AND INFORMATION REGARDING THE DISPOSAL OF USED PACKAGING MATERIALS

Dispose of used packaging material at a site designated for waste in your municipality.

DISPOSAL OF USED ELECTRICAL AND ELECTRONIC EQUIPMENT

This symbol on products or original documents means that used electric or electronic products must not be added to ordinary municipal waste. For proper disposal, renewal and recycling hand over these appliances to determined collection points. Alternatively, in some European Union states or other European countries you may return your appliances to the local retailer when buying an equivalent new appliance.



Correct disposal of this product helps save valuable natural resources and prevents potential negative effects on the environment and human health, which could result from improper waste disposal. Ask your local authorities or collection facility for more details.

In accordance with national regulations penalties may be imposed for the incorrect disposal of this type of waste.

For business entities in European Union states

If you want to dispose of electric or electronic appliances, ask your retailer or supplier for the necessary information.

Disposal in other countries outside the European Union

This symbol is valid in the European Union. If you wish to dispose of this product, request the necessary information about the correct disposal method from the local council or from your retailer.



This product meets all the basic requirements of EU directives related to it.