

Electric Coffee Grinder

User's manual

EN



SENCOR®

SCG 1050WH
SCG 1050BK

Prior to using this appliance, please read the user's manual thoroughly, even in cases where owners have previously familiarised themselves with using similar types of appliances. Only use the appliance in the manner described in this user manual. Keep this manual for future use.

Save the original shipping box, packaging material, purchase receipt and warranty card for the duration of the warranty. In the event of shipping, pack the appliance using the original packaging materials only.

Electric Coffee Grinder

SCG 1050WH / SCG 1050BK

CONTENTS

IMPORTANT SAFETY INSTRUCTIONS	3
DESCRIPTION OF THE COFFEE GRINDER	5
BEFORE FIRST USE	6
USING THE COFFEE GRINDER	6
CLEANING AND MAINTENANCE	6
STORAGE	7
TECHNICAL SPECIFICATIONS	7
INSTRUCTIONS AND INFORMATION REGARDING THE DISPOSAL OF USED PACKAGING MATERIALS ..	8
DISPOSAL OF USED ELECTRICAL AND ELECTRONIC EQUIPMENT	8

IMPORTANT SAFETY INSTRUCTIONS

- Children must not use this appliance or play with it. Keep this appliance and the power cord out of reach of children.
- This appliance may be used by persons with physical or mental impairments or by inexperienced persons if they are properly supervised or have been informed about how to use of the product in a safe manner and understand the potential dangers.

Electric Coffee Grinder

SCG 1050WH / SCG 1050BK

IMPORTANT SAFETY INSTRUCTIONS READ CAREFULLY AND STORE FOR FUTURE USE.

- Before connecting this appliance to a wall socket, make sure the voltage stated on the rating label of the appliance corresponds to the voltage in your wall socket.
- This appliance is designed for grinding coffee beans. The appliance can be used at home, in the office, etc.
- Do not use the appliance in industrial surroundings or outdoors!
- Do not place the appliance on unstable surfaces.
- Only place the appliance on an even, dry and stable surface.
- Ensure that the power plug contacts do not come into contact with water or moisture.
- Do not spray the appliance with water or any other liquid. Never wash it under running water or submerge it in water or another liquid.
- Do not turn on the appliance when it is empty. The incorrect use of the appliance may negatively affect its lifetime.
- The maximum continuous operating time is 30 seconds. After 30 seconds of continuous operation allow the appliance to rest for 2 minutes.
- Always turn off the appliance and disconnect from the power socket if you will not be using it and if you are leaving it without supervision, before mounting or removing the lid and before cleaning.
- Do not place the appliance on an electric or gas stove or in its vicinity, do not place it in the vicinity of an open fire or an appliance that is a source of heat.
- Do not place heavy items on the power cord. Make sure the power cord does not hang over the edge of a table or that it does not touch a hot surface.
- Do not disconnect the appliance from the power socket by pulling on the power cord. This could damage the power cord or the power socket. Disconnect the cord from the power socket by gently pulling the plug of the power cord.
- If the power cord is damaged, have it replaced at a professional service centre. It is forbidden to use the appliance if it has a damaged power cord or plug.
- To avoid the danger of injury by electrical shock, do not repair the appliance yourself or make any adjustments to it. Have all repairs or adjustments of the appliance performed at an authorised service centre. Tampering with the appliance during the warranty period may void the warranty policy.

Electric Coffee Grinder

SCG 1050WH / SCG 1050BK

EN

DESCRIPTION OF THE COFFEE GRINDER

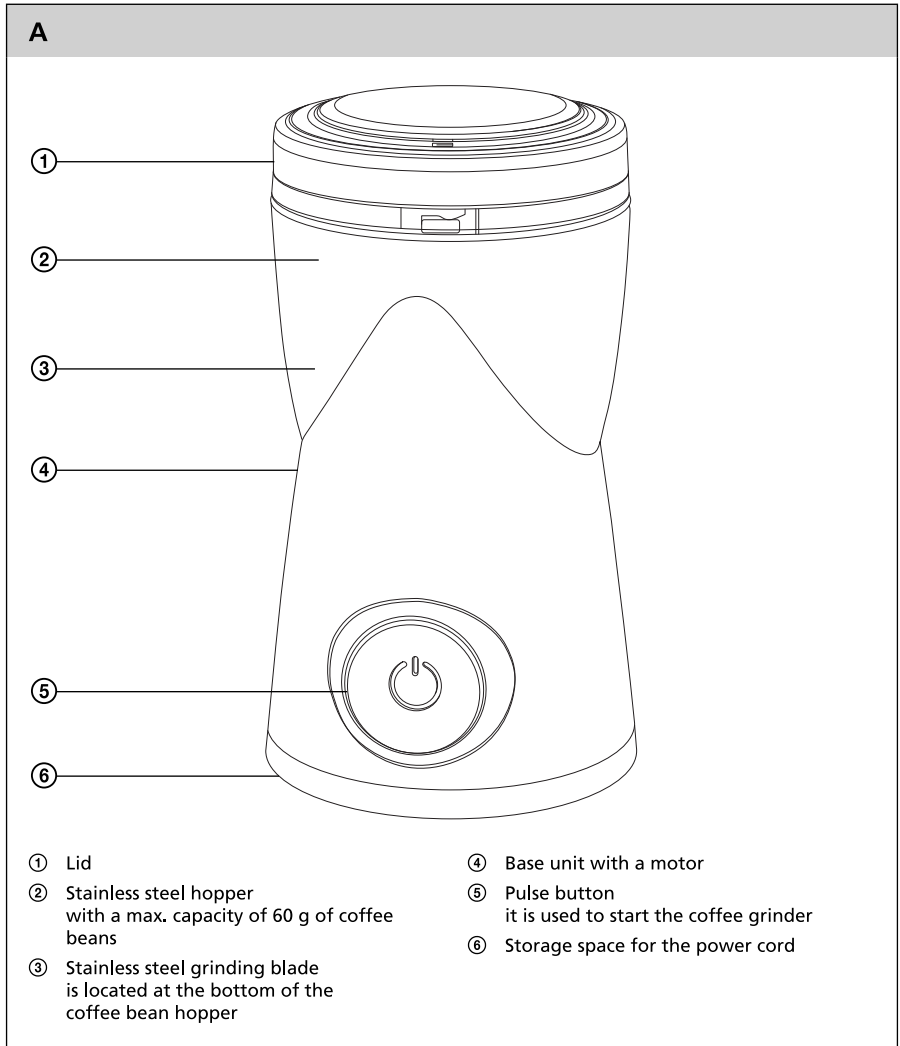

Electric Coffee Grinder

SCG 1050WH / SCG 1050BK

BEFORE FIRST USE

1. Remove the coffee grinder from the packing material.
2. Remove the lid A① by turning it anticlockwise. Wash the lid A① under running water using kitchen detergent. Then rinse it under running water and dry thoroughly. Wipe the hopper A② and the grinding blade A③ with a lightly dampened wiping cloth and then wipe it until it is thoroughly dry.

**Attention:**

When cleaning the grinding blade A③, be very careful not to injure yourself with it.

USING THE COFFEE GRINDER

1. Wind the power cord out of the storage area A⑥.
2. Remove the lid A① by turning it anticlockwise. Pour coffee beans into the hopper A②. The maximum capacity of the hopper A② is 60 g. Do not fill it up above the edge.
3. Place the lid A① on to the hopper A② and turn it clockwise until you hear an audible click. Now the lid A① is locked in place and will not come off by itself.
4. Connect the coffee grinder to an el. power socket and press the pulse button A⑤ to start the coffee grinder. The coffee grinder will continue to run while the button A⑤ is pressed. The coarseness of the ground coffee can be regulated by the grinding time. The longer you grind it, the finer it will be.

**Attention:**

The coffee grinder is equipped with a safety feature that prevents its operation if the lid is not correctly attached.

The maximum continuous operating time is 30 seconds. After 30 seconds of continuous operation allow the coffee grinder to rest for 2 minutes.

**Tip:**

Always prepare your coffee beverage from freshly ground coffee. Coffee that is ground in advance loses its flavour and aroma.

5. To end the operation, release the pulse button A⑤. Disconnect the coffee grinder from the el. power socket. Turn the lid A① anticlockwise to release it, then take it off. Tip the ground coffee into a suitable container.
6. If you wish to grind another batch of coffee, repeat the above procedure.
7. Always disconnect the coffee grinder from the el. power socket after finishing using it and clean it out according to the instructions contained in the chapter Cleaning and maintenance.

CLEANING AND MAINTENANCE

- Before cleaning the appliance, disconnect it from the power socket.
- Clean the lid A① using warm water with kitchen detergent after every use. Then rinse it with clean water and dry thoroughly with a fine wiping cloth.
- Clean the remaining ground coffee out of the hopper A② and off the grinding blade A③. Then wipe with a dampened wiping cloth and then thoroughly wipe it out until dry.

**Attention:**

When cleaning the grinding blade A③, be very careful not to injure yourself with it.

Electric Coffee Grinder

SCG 1050WH / SCG 1050BK

EN

- Use a dry or dampened wiping cloth for cleaning the base unit A④.
- Never submerge the base unit in water or any other liquid.
- Do not use solvents or thinners, abrasive cleaning products, etc. for cleaning any part of the appliance. Otherwise the surface coat of the appliance may be damaged.

STORAGE

- If you will not be using the appliance, store it in a dry place out of children's reach. Prior to storing the appliance, wind up the power cord into the storage area A⑥ and close the lid A① so that dust does not accumulate inside the hopper A②.

TECHNICAL SPECIFICATIONS

Nominal voltage.....	230 V
Nominal frequency.....	50/60 Hz
Rated power input.....	150 W
Safety class (for electric shock protection)	II
Noise level.....	83 dB (A)

The declared noise emission level of the appliance is 83 dB (A), which represents a level A of acoustic power with respect to a reference acoustic power of 1 pW.

Glossary of technical terms

Safety class for electric shock protection:

Class II – Electric shock protection is provided by double or heavy-duty insulation.

Amendments to text and technical parameters are reserved.

INSTRUCTIONS AND INFORMATION REGARDING THE DISPOSAL OF USED PACKAGING MATERIALS

Dispose of packaging material at a public waste disposal site.

DISPOSAL OF USED ELECTRICAL AND ELECTRONIC EQUIPMENT



The meaning of the symbol on the product, its accessory or packaging indicates that this product shall not be treated as household waste. Please, dispose of this product at your applicable collection point for the recycling of electrical & electronic equipment waste. Alternatively in some states of the European Union or other European states you may return your products to your local retailer when buying an equivalent new product. The correct disposal of this product will help save valuable natural resources and help in preventing the potential negative impact on the environment and human health, which could be caused as a result of improper liquidation of waste. Please ask your local authorities or the nearest waste collection centre for further details. The improper disposal of this type of waste may fall subject to national regulations for fines.

For business entities in the European Union

If you wish to dispose of an electrical or electronic device, request the necessary information from your seller or supplier.

Disposal in other countries outside the European Union

If you wish to dispose of this product, request the necessary information about the correct disposal method from local government departments or from your seller.



This product meets all the basic EU regulation requirements that relate to it.