

# Blender

User's manual

EN



**SENCOR®**

SBL 3271SS

SBL 3272RD

Prior to using this appliance, please read the user's manual thoroughly, even in cases, when one has already familiarised themselves with previous use of similar types of appliances. Only use the appliance in the manner described in this user's manual. Keep this user's manual in a safe place where it can be easily retrieved for future use.

We recommend saving the original cardboard box, packaging material, purchase receipt and responsibility statement of the vendor or warranty card for at least the duration of the legal liability for unsatisfactory performance or quality. In the event of transportation, we recommend that you pack the appliance in the original box from the manufacturer.

EN-1

## TABLE OF CONTENTS

IMPORTANT SAFETY INSTRUCTIONS .....	3
DESCRIPTION OF THE APPLIANCE .....	6
BEFORE FIRST USE .....	7
ASSEMBLING AND DISASSEMBLING THE APPLIANCE .....	7
OPERATING THE APPLIANCE .....	8
QUICK GUIDE TO PROCESSING INGREDIENTS.....	9
CLEANING AND MAINTENANCE.....	10
STORAGE.....	10
TECHNICAL SPECIFICATIONS .....	11
INSTRUCTIONS AND INFORMATION REGARDING THE DISPOSAL OF USED PACKAGING MATERIALS ....	11
DISPOSAL OF USED ELECTRICAL AND ELECTRONIC EQUIPMENT.....	11

## **IMPORTANT SAFETY INSTRUCTIONS READ CAREFULLY AND STORE FOR FUTURE USE.**

- This appliance can be used by persons with reduced physical, sensory or mental capabilities or lack of experience and knowledge if they have been given supervision or instruction concerning use of the appliance in a safe way and if they understand the hazards involved.
- Children shall not use the appliance and play with it. Keep this appliance and its power cord out of the reach of children.
- Before connecting this appliance to a power socket, make sure the voltage stated on its rating label corresponds to the voltage in your power socket.
- Use the appliance only with the original accessories supplied with it.
- The appliance is intended and designed for processing a standard amount of food in the household.
- Do not use this appliance for other than its intended use.
- Do not use the appliance in an industrial environment or outdoors.
- Do not place the appliance on an electric or gas stove or in its vicinity, on the edge of a table or on an unstable surface. Only place the appliance on an even, dry and stable surface.
- Always ensure the appliance is properly assembled before operating.
- Hot liquids or foods need to be allowed to cool down to at least 50 °C before being placed inside the blending jar.
- Do not leave the appliance in continuous operation for longer than 2 minutes. Before turning it on again, allow it to cool down for at least 2 minutes. When processing hard foods or liquids with a very thick consistency, do not leave the appliance in continuous operation for longer than 1 minute.
- While blending, do not put your hands or items, such as kitchen knives, forks or wooden spoons into the blending jar.

Otherwise, an injury could occur or the appliance could be damaged.

- In the event that food is sticking to the blade assembly or the walls of the blending jar, turn the appliance off by turning the speed dial to position 0 (Off) and disconnect it from the power socket. Ensure the blade assembly has stopped rotating. Carefully remove the blending jar from the motor unit. Remove the lid and using a plastic spatula clean the blade assembly and the walls of the blending jar. Put the lid back on and reattach the blending jar to the motor unit. Plug the power cord into a power socket and continue blending.
- Do not submerge the motor unit and its power cord in water or any other liquid, or wash these parts under running water.
- When handling the blade assembly, when taking it out of the blending jar or grinder and when cleaning it, take special care to avoid injury. The blades are sharp.
- Do not turn the appliance on when empty. The incorrect use of the appliance may negatively affect its lifetime.
- Always turn off the appliance by turning the speed dial to position 0 (Off) and disconnect it from the power socket when not in use and when leaving it without supervision, before assembly, disassembly, changing accessories, before cleaning or moving it.
- Check that the motor unit is turned off, disconnected from the power socket and that the rotating parts have come to a complete stop before removing the blending jar or grinder from the motor unit.
- Ensure that the power plug does not come into contact with moisture. Do not place heavy items on the power cord. Make sure the power cord does not hang over the edge of a table or that it does not touch a hot surface.
- Do not disconnect the appliance from the power socket by pulling on the power cord. This could damage the power cord or the power socket. Disconnect the cord from the power socket by gently pulling on the plug of the power cord.

# Blender

SBL 3271SS / SBL 3272RD

EN

- If the power cord is damaged, have it replaced at a professional service centre. It is forbidden to use the appliance if it has a damaged power cord or plug.
- Do not use the appliance when it is not operating properly or showing signs of damage.
- In order to prevent a hazardous situation arising, do not repair the appliance yourself or modify it in any way. Have all repairs performed at an authorised service centre. By tampering with the appliance you risk voiding your legal rights arising from unsatisfactory performance or quality warranty.

## DESCRIPTION OF THE APPLIANCE

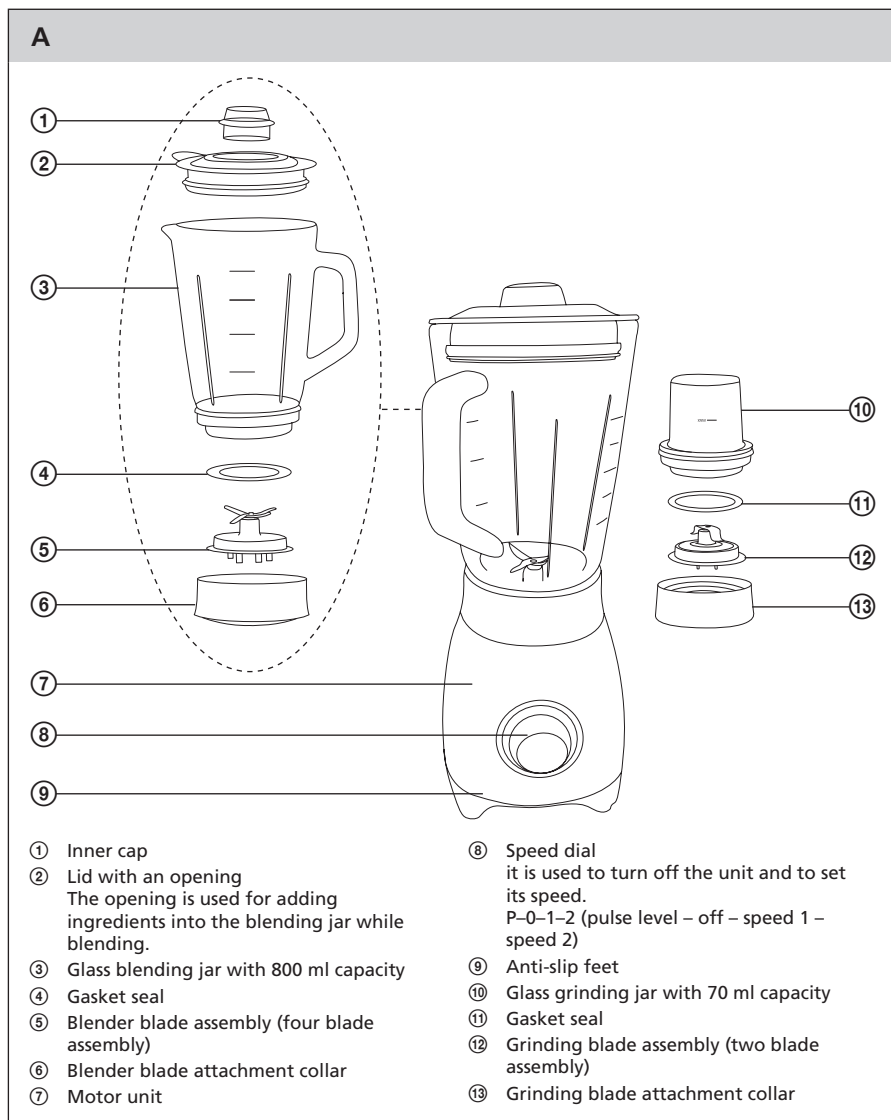
**Note:**

The blender comes with 1 spare gasket seal.

## BEFORE FIRST USE

1. Take the appliance and its accessories out of the packaging materials.
2. Thoroughly wash all parts intended for contact with food (inner cap A①, outer lid A②, blending jar A③, gasket seal A④ and A⑪, blade assembly A⑤ and A⑫, attachment collar A⑥ and A⑬, grinding jar A⑩), using warm water and a neutral kitchen detergent. Then rinse them with clean water and dry thoroughly with a fine wiping cloth.



### Attention:

When cleaning the blending and grinding blade assemblies A⑤ and A⑫ take special care to avoid injury. The blades A⑤ and A⑫ are sharp.

## ASSEMBLING AND DISASSEMBLING THE APPLIANCE

- Before you start assembling or disassembling the appliance, check that the motor unit A⑦ is turned off and disconnected from the power socket and that the rotating parts have come to a complete stop.

### 1. Assembling and disassembling the blending jar

- 1.1 Place the gasket seal A④ on to the blade assembly A⑤. Make sure that the gasket seal A④ properly adheres along the entire perimeter of the blade assembly A⑤.
- 1.2 Place the blade assembly A⑤ with the gasket seal A④ into the attachment collar A⑥. Then, from underneath, place this assembly against the blending jar A③. Screw the collar A⑥ to the blending jar A③ anticlockwise and tighten firmly.
- 1.3 Place the inner cap A① into the opening in the lid A② so that the tabs along the perimeter of the cap A① slide into the grooves in the lid A②. Turn the cap A① clockwise to secure it in the lid A②. When you have placed all the necessary ingredients into the blending jar A③, close it with the assembled lid. The lid needs to be properly pushed down along the entire perimeter so that it adheres well to the edge of the blending jar A③.
- 1.4 When disassembling the blending jar, proceed in the reverse sequence.

### 2. Assembling and disassembling the grinder

- 2.1 Turn the grinding jar A⑩ so that the opening faces upwards. Place the gasket seal A⑪ on to the blade assembly A⑫. Make sure that the gasket seal A⑪ properly adheres along the entire perimeter of the blade assembly A⑫.
- 2.2 Place the blade assembly A⑫ with the gasket seal A⑪ into the opening of the jar A⑩ so that the blades point into the jar A⑩. Attach the blade unit A⑫ to the jar A⑩ by screwing collar A⑬ clockwise. Turn the assembled grinder so that the collar A⑬ is facing downwards.



### Note:

Place food into the jar A⑩ before attaching it to the blade assembly A⑫.

Unless you are grinding coffee beans, use blade assembly A⑥ instead of blade assembly A⑫. Further instructions regarding the selection of the correct type of blade assembly can be found in chapter Quick guide to processing ingredients.

- 2.3 When disassembling the grinder, proceed in the reverse sequence.

### 3. Attaching the blending jar and grinder to the motor unit and their removal

- 3.1 Place the motor unit A⑦ on an even, dry surface, for example on a kitchen countertop. On to the motor unit A⑦ place the blending jar or grinder assembly and turn it clockwise all the way so that it is secured on the motor unit A⑦. When the blending jar or grinder assembly is correctly attached to the motor unit A⑦, it is not possible to freely lift it off the motor unit A⑦.

# Blender

SBL 3271SS / SBL 3272RD

**Attention:**

The safety mechanism will prevent the appliance from being started unless the blending jar or grinder assembly is properly attached to the motor unit A⑦.

3.2 To remove the blending jar or grinder from the motor unit A⑦, proceed in the reverse sequence.

## OPERATING THE APPLIANCE

### 1. Using the blender

- 1.1 Make sure that the motor unit A⑦ is turned off and disconnected from the mains power socket.
- 1.2 Assemble the blender according to the instructions in chapter Assembling and disassembling the appliance.
- 1.3 Place the food or pour the liquids that you wish to blend into the blending jar A③. Close the blending jar A③ using the lid according to the instructions in chapter Assembling and disassembling the appliance.

**Note:**

The maximum capacity of the blending jar A③ is 800 ml. We recommend that the blending jar is not filled with more than 600 ml of liquids. Certain liquids increase their volume during mixing, and therefore it is better to blend them gradually in smaller batches.

- 1.4 Connect the power cord to the power socket and set the speed dial A⑧ to the required speed level of 1 or 2. Level 1 is slower and level 2 is faster. We recommend to first set the slower speed to allow the ingredients to mix together. Then you can increase the speed to level 2. While blending, always use your hand to hold down the lid A② from above. The pulse level is appropriate when you wish to blend food only very quickly. To start the pulse level, turn the speed dial A⑧ to the position "P" and hold it in this position for a moment. As soon as you release the speed dial A⑧, it will automatically return to position 0 (Off).

**Attention:**

The maximum operating time is 2 minutes. Do not leave the appliance in continuous operation for longer than indicated above. Then allow the appliance to cool down for 2 minutes. When processing hard food or liquids with a very thick consistency, do not leave the appliance in continuous operation for longer than 1 minute.

- 1.5 While blending, you may add food or liquids to the blending jar A③ through the hole in the lid A② after removing the inner cap A①.
- 1.6 In the event that food is sticking to the blade assembly A⑤ or the walls of the blending jar A③, turn the appliance off by turning the speed dial to position 0 (Off) and disconnect it from the power socket. Make sure that the blade assembly A⑤ has stopped rotating. Carefully remove the blending jar from the motor unit A⑦. Take off the lid A② and using a plastic spatula clean the blade assembly A⑤ and the walls of the blending jar A③. Put the lid A② back on and reattach the blending jar to the motor unit A⑦. Plug the power cord into a power socket and continue blending.
- 1.7 After you have finished using the appliance, set the speed dial A⑧ to position 0 (Off) and disconnect the power cord from the power socket. Check that the blade assembly A⑤ has stopped rotating and take the blending jar off the motor unit A⑦. Use a soft plastic spatula to remove food from the blending jar A③.
- 1.8 Disassemble the blending jar according to the instructions contained in chapter Assembling and disassembling the appliance, and clean it according to the instructions in chapter Cleaning and maintenance.

### 2. Using the grinder

- 2.1 Make sure that the motor unit A⑦ is turned off and disconnected from the mains power socket.
- 2.2 Place the food that you wish to grind up into the grinding jar A⑩. The grinder is suitable for grinding nuts (with shells removed), coffee beans, spices, etc. The maximum amount of food that can be placed in the jar A⑩ is indicated by the MAX mark. Do not overfill the jar A⑩.



# Blender

SBL 3271SS / SBL 3272RD

When using the grinder, proceed according to the instructions in the guide for processing ingredients on pages 9 and 10.

- 2.3 Assemble the grinder and attach it to the motor unit A⑦ according to the instructions in chapter Assembling and disassembling the appliance.
- 2.4 Connect the power cord to the power socket and set the speed dial A⑧ to the required speed level of 1 or 2. Level 1 is slower and level 2 is faster. We recommend to first set the slower speed. Then you can increase the speed to level 2. The pulse level is appropriate when you wish to blend food only very quickly. To start the pulse level, turn the speed dial A⑧ to the position "P" and hold it in this position for a moment. As soon as you release the speed dial A⑧, it will automatically return to position 0 (Off).



**Attention:**

The maximum operating time is 2 minutes. Do not leave the appliance in continuous operation for longer than indicated above. Then allow the appliance to cool down for 2 minutes. When processing hard foods, do not leave the appliance in continuous operation for longer than 1 minute.

- 2.5 After you have finished using the appliance, set the speed dial A⑧ to position 0 (Off) and disconnect the power cord from the power socket. Check that the grinding blade assembly A⑤ has stopped rotating and take the grinder off the motor unit A⑦.
- 2.6 Disassemble the grinder according to the instructions in chapter Assembling and disassembling the appliance. Use a soft plastic spatula to remove food from the blending jar A⑩. Then clean all used parts according to the instructions in chapter Cleaning and maintenance.

### 3. Advice and tips for blending

- First cut food with a firm consistency such as fruit and vegetables into smaller pieces measuring 2 to 3 cm and only then place it inside the blending jar A③.
- It is better to separate larger amounts of ingredients into several smaller batches. First blend one batch and then gradually add further batches through the hole in the outer lid A② while blending. In this way, you will achieve better results than by adding all ingredients into the blending jar A③ at once. Before adding every additional batch, first check that the maximum capacity of the blending jar A③ will not be exceeded.
- If you need to blend food of a solid consistency together with liquids, we recommend that you first blend the food of solid consistency with a smaller amount of the liquids. Then gradually add the remaining liquids through the hole in the outer lid A② while blending. While blending, always use your hand to hold down the lid A② from above.
- To blend very thick liquids, we recommend using the pulse level so that the blade assembly A⑤ does not get jammed. Start the blender repeatedly in short intervals.
- Ice cubes must be processed immediately upon being removed from the freezer. When the ice starts to melt, the ice cubes will stick together and it will not be possible to blend them.

## QUICK GUIDE TO PROCESSING INGREDIENTS

### Blender (four blade assembly)

Ingredients	Speed selection	Recommended blending time
Fruit, vegetables cut into smaller pieces	1	30 s
Baby food	1	40 s
Spreads, dressings, marinades	1	30 s
Smoothies and cocktails	2	40 s
Soups	2	30 s
Ice cubes	P (Pulse level)	–

# Blender

SBL 3271SS / SBL 3272RD

## Grinder (two blade assembly)

Ingredients	Speed selection	Recommended mixing time
Coffee beans	P (Pulse level)	–

## Grinder (four blade assembly)

Ingredients	Speed selection	Recommended mixing time
Pepper	2 + Pulse level	30 s
Bay leaf	2 + Pulse level	30 s
Crystal sugar	2 + Pulse level	30 s
Allspice	2 + Pulse level	30 s
Garlic	2 + Pulse level	30 s
Nuts (with shells removed)	2 + Pulse level	40 s



### Note:

The above food processing times are only a reference. The actual mixing time depends on the size of the ingredients, their amount and the required final consistency.

## CLEANING AND MAINTENANCE

- Before cleaning make sure that the appliance is turned off, disconnected from the power socket and that the rotating parts have stopped.
- Disassemble the blending jar or grinder assembly according to the instructions in chapter Assembling and disassembling the appliance. Thoroughly wash the individual parts of the blending jar or grinder using warm water and a neutral kitchen detergent. Then rinse them under clean running water and thoroughly wipe dry with a fine wiping cloth or allow them to dry naturally. These parts may also be washed in a dishwasher.



### Attention:

When removing and cleaning the blending or grinding blade assemblies A⑤ and A⑩ take special care to avoid injury. The blades A⑤ and A⑩ are sharp.

- To clean the outer surface of the motor unit A⑦, use a cloth dipped in a weak detergent solution. After applying the kitchen detergent, wipe the surface with a cloth lightly dampened in clean water and then wipe dry.
- Never submerge the motor unit A⑦ or the power cord in water or in any other liquid. Do not use thinners or solvents or cleaning agents causing abrasion to clean the appliance. Otherwise the surface of the appliance may be damaged.

## STORAGE

- Store the appliance in a dry place out of the reach of children.

# Blender

SBL 3271SS / SBL 3272RD

EN

## TECHNICAL SPECIFICATIONS

Rated voltage range .....	220–240 V
Rated frequency .....	50/60 Hz
Rated power input .....	250 W
Noise level .....	87 dB(A)

The declared noise emission level of the appliance is 87 dB(A), which represents a level A of acoustic power with respect to a reference acoustic power of 1 pW.

Changes to text and technical parameters are reserved.

### INSTRUCTIONS AND INFORMATION REGARDING THE DISPOSAL OF USED PACKAGING MATERIALS

Dispose of used packaging material at a site designated for waste in your municipality.

### DISPOSAL OF USED ELECTRICAL AND ELECTRONIC EQUIPMENT



This symbol on products or original documents means that used electric or electronic products must not be added to ordinary municipal waste. For proper disposal, renewal and recycling hand over these appliances to determined collection points. Alternatively, in some European Union states or other European countries you may return your appliances to the local retailer when buying an equivalent new appliance.

Correct disposal of this product helps save valuable natural resources and prevents potential negative effects on the environment and human health, which could result from improper waste disposal. Ask your local authorities or collection facility for more details.

In accordance with national regulations penalties may be imposed for the incorrect disposal of this type of waste.

#### For business entities in European Union states

If you want to dispose of electric or electronic appliances, ask your retailer or supplier for the necessary information.

#### Disposal in other countries outside the European Union.

This symbol is valid in the European Union. If you wish to dispose of this product, request the necessary information about the correct disposal method from the local council or from your vendor



This appliance meets all the basic requirements of EU directives related to it.

# Blender

SBL 3271SS / SBL 3272RD